

GREENVILLE CO. S. C.

NOV 1 4 03 PM 1965

OLLIE H. KANSWORTH
R.M.C.

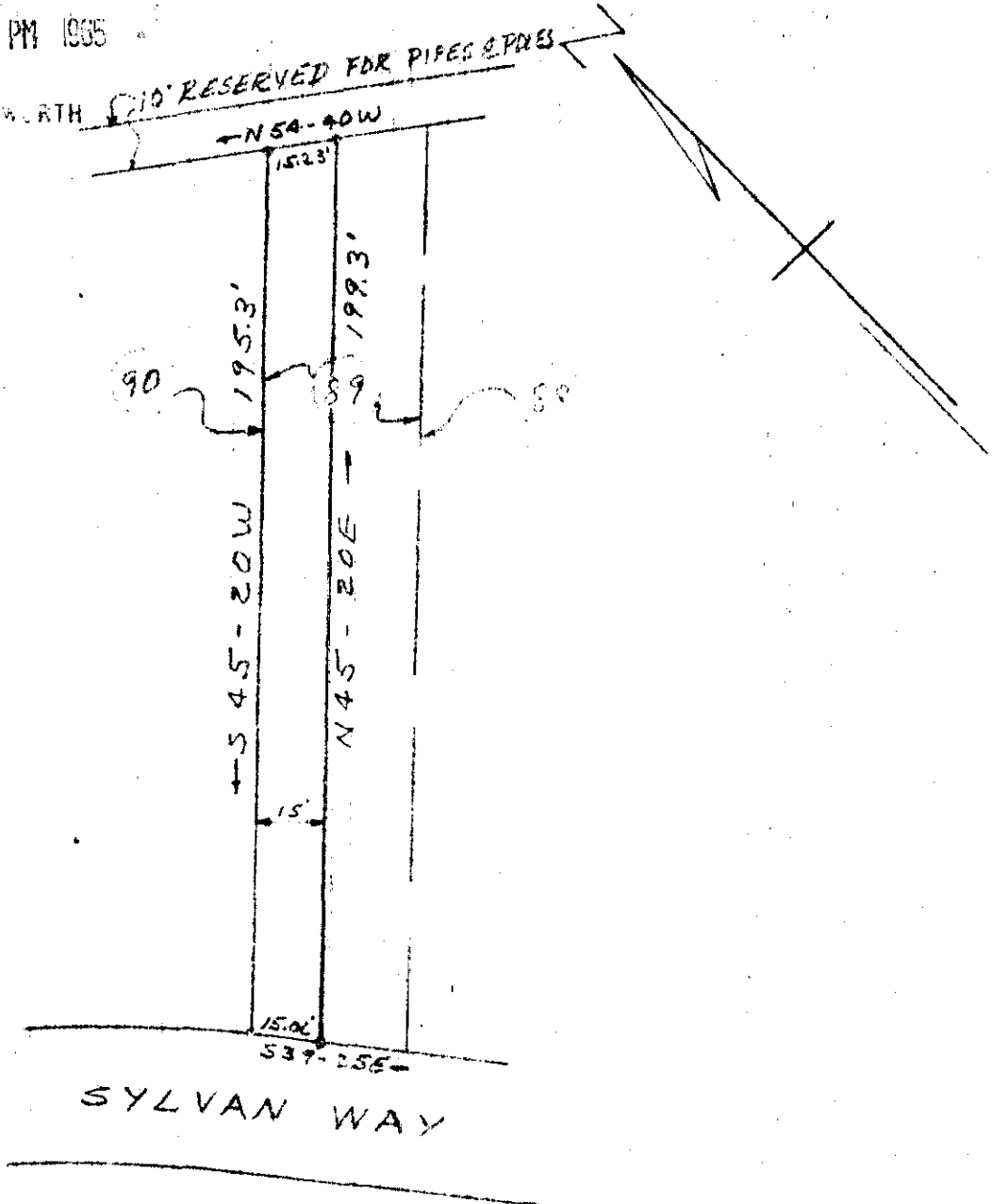

PROPERTY OF
GERALD S. TOMPKINS JR.
GREENVILLE, S. C.

888-69

OCT. 29, 1965 SCALE: 1" = 40'

NOV 1 1965
13438

SURVEY OF 15' STRIP OF
LOT NO 87, MARSHALL FOREST,
BY: H. C. Clarkham
S.C.R.L.S. NO 2589

REFERENCE:
R.M.C. OFFICE, GREENVILLE CO.
PLAT BOOK H
PAGES NO 133 & 134

13438 Filed This 1 day of Nov. 1965
And Recorded in Vol. 888 Page 69 at 4:03 PM
Ollie H. Kansworth
Register Mesne Conveyance Greenville County, S. C.